

TABLE OF CONTENTS

Table of Contents 1
1.Overview 2
2.Preparation 2
3.Procedure..... 3
4.Restoration 4



FERROUS MATERIAL HAZARD! THE CRIMP TOOL, AND OTHER TOOLS AND PARTS REQUIRED FOR THIS INSTALLATION CONTAIN FERROUS MATERIAL AND WILL BE STRONGLY ATTRACTED TO MAGNET AND MAY BECOME DANGEROUS PROJECTILES. IF MAGNET IS AT FULL FIELD – KEEP ALL FERROUS TOOLS AT LEAST 10 FEET AWAY FROM THE MAGNET.

Rev 0

1. Overview

This document describes PCM lamp replacement located on PCM.

Bulb Location:

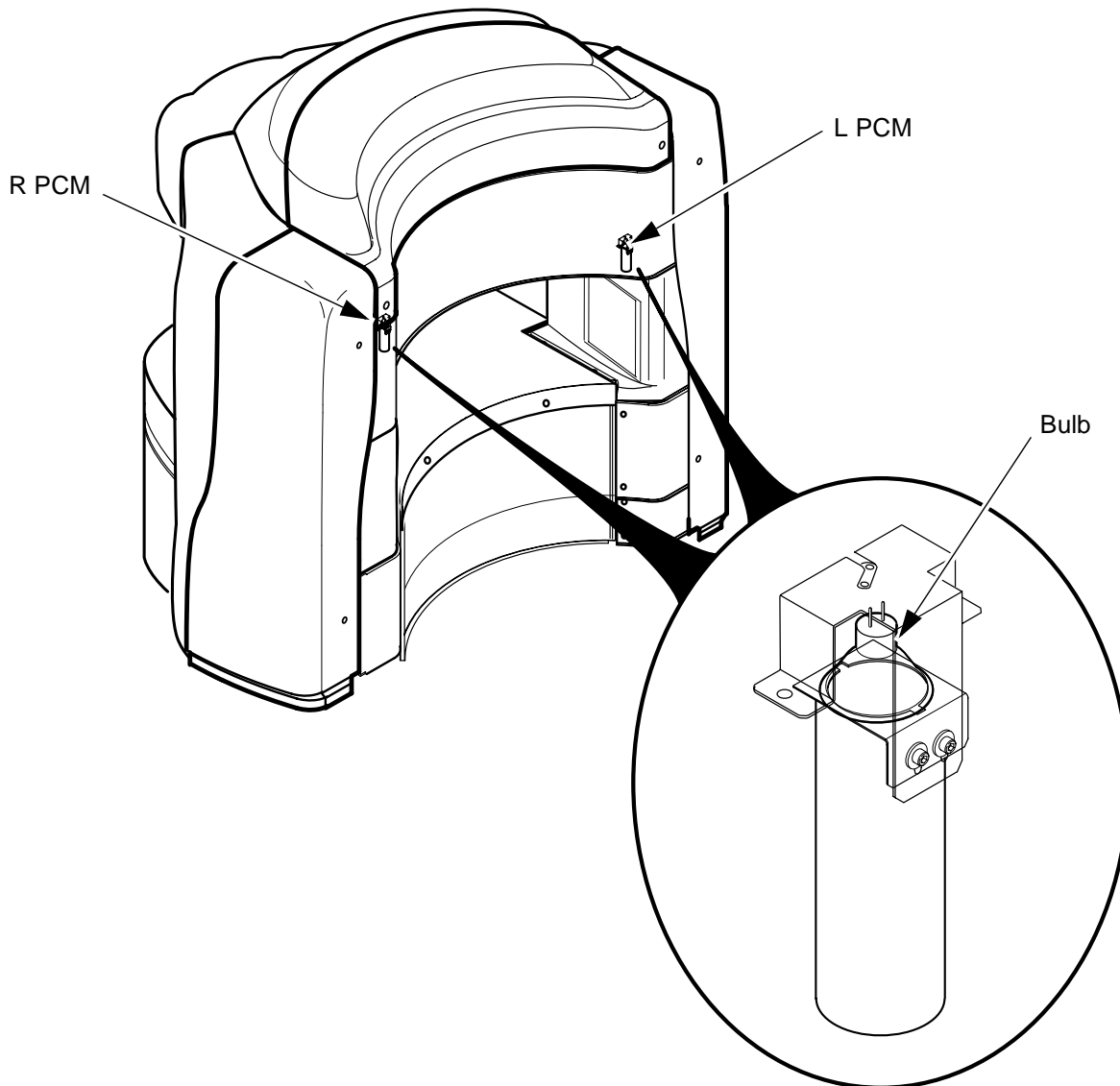

2. Preparation

Turn PCM Lamp SW to OFF on display panel.

Required Tool:

Items	Qty	Type/Parts Number	Part
Metric Allen Wrench Set	1	Non ferrous	PCM Cover

Rev 0

3. Procedure

1. Remove the R and/or L PCM Cover by removing 3 screws(U0438AA) and 3 caps for each side.

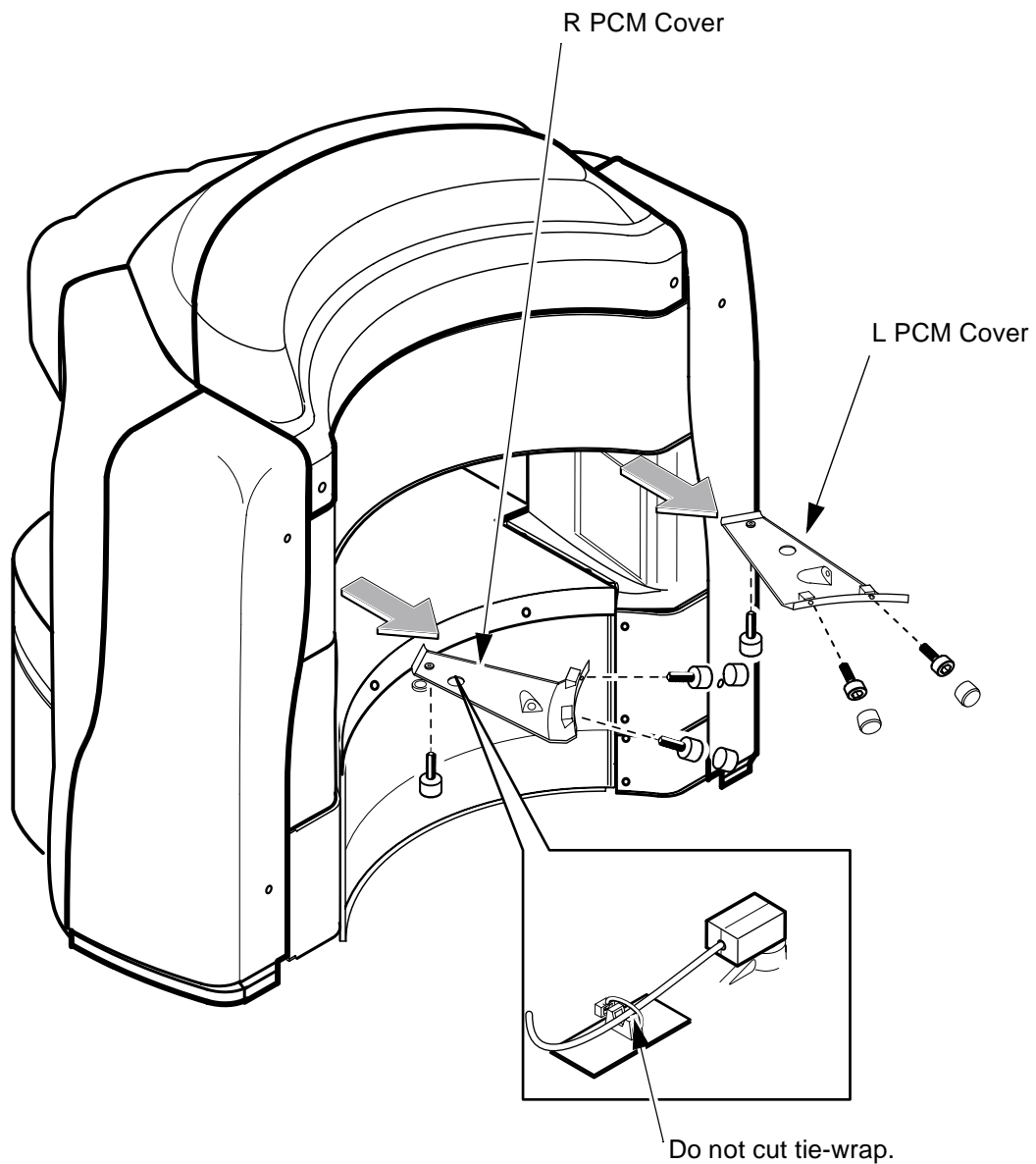

**BULB REPLACEMENT
ILLUSTRATION 1**

Rev 0

3. Procedure(Continued)

2. Remove light pipe by removing 2 screws and washers.
3. Replace lamp.
4. Install light pipe aligning lugs of bulb inner and grooves of light pipe with 2 screws and washers.

NOTE:Do not touch the bulb and reflector surface.

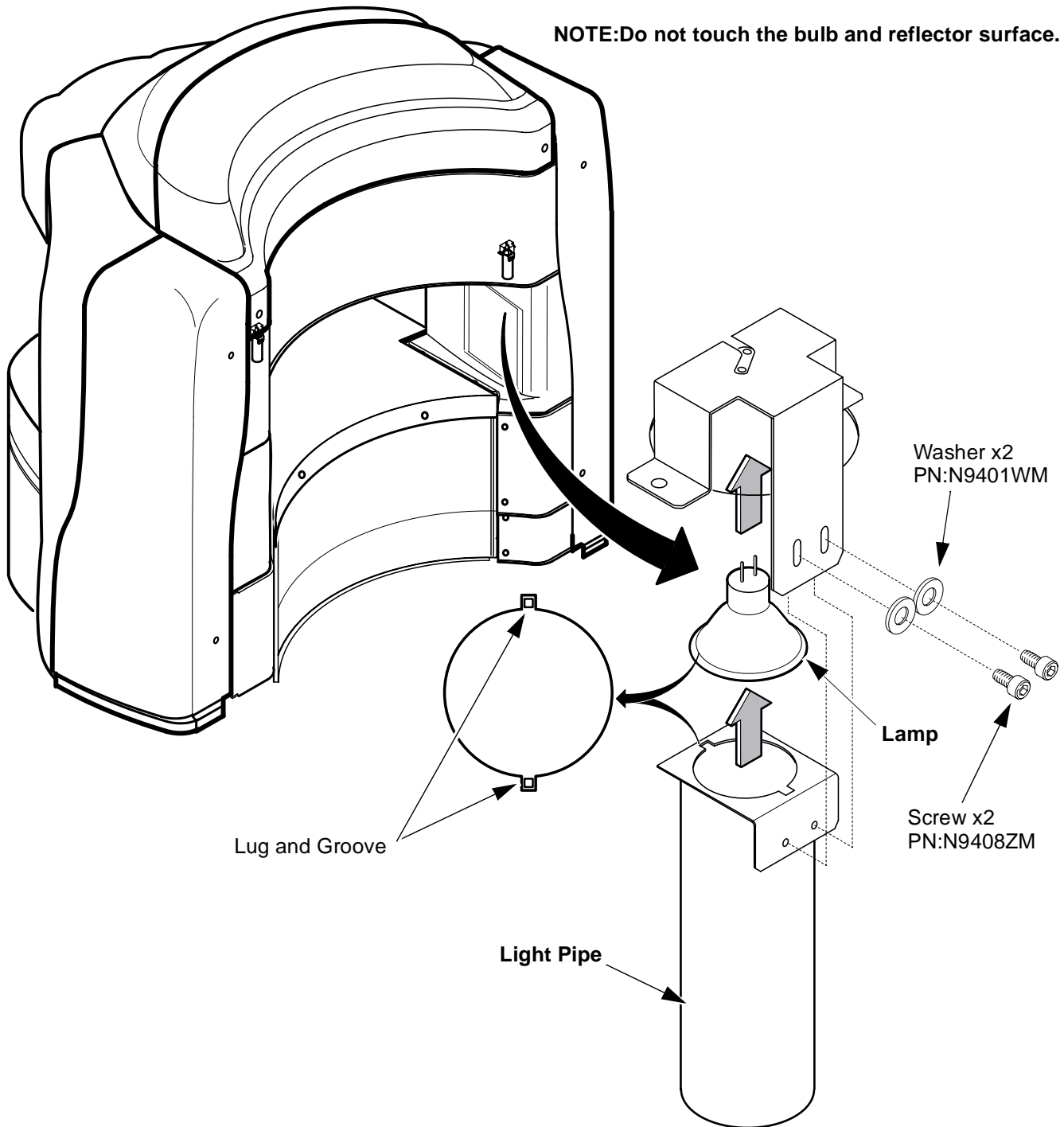

**BULB REPLACEMENT
ILLUSTRATION 2**

4. Restoration

1. Turn PCM light SW to ON.
2. The PCM cover installation is reverse order of removal.

Rev 0

Revision History

Rev	Date	Author	Primary Reasons For Change
0	Oct. 03, 2001	K.Tsumagari	Initial Version