

TABLE OF CONTENTS

Table of Contents 1
1.Overview 2
2.Preparation 2
3.Procedure..... 3
4.Restoration 8



FERROUS MATERIAL HAZARD! THE CRIMP TOOL, AND OTHER TOOLS AND PARTS REQUIRED FOR THIS INSTALLATION CONTAIN FERROUS MATERIAL AND WILL BE STRONGLY ATTRACTED TO MAGNET AND MAY BECOME DANGEROUS PROJECTILES. IF MAGNET IS AT FULL FIELD – KEEP ALL FERROUS TOOLS AT LEAST 10 FEET AWAY FROM THE MAGNET.

Rev 1

1. Overview

This document describes replacement of the QHB Assy located on Magnet rear side. The QHB Assy is composed of Bias Box, Body QHB assy and Pre-amp. The QHB is installed to opposite side of wiring side. This procedure is QHB of L side layout.

Location:

The illustration is R side wiring.

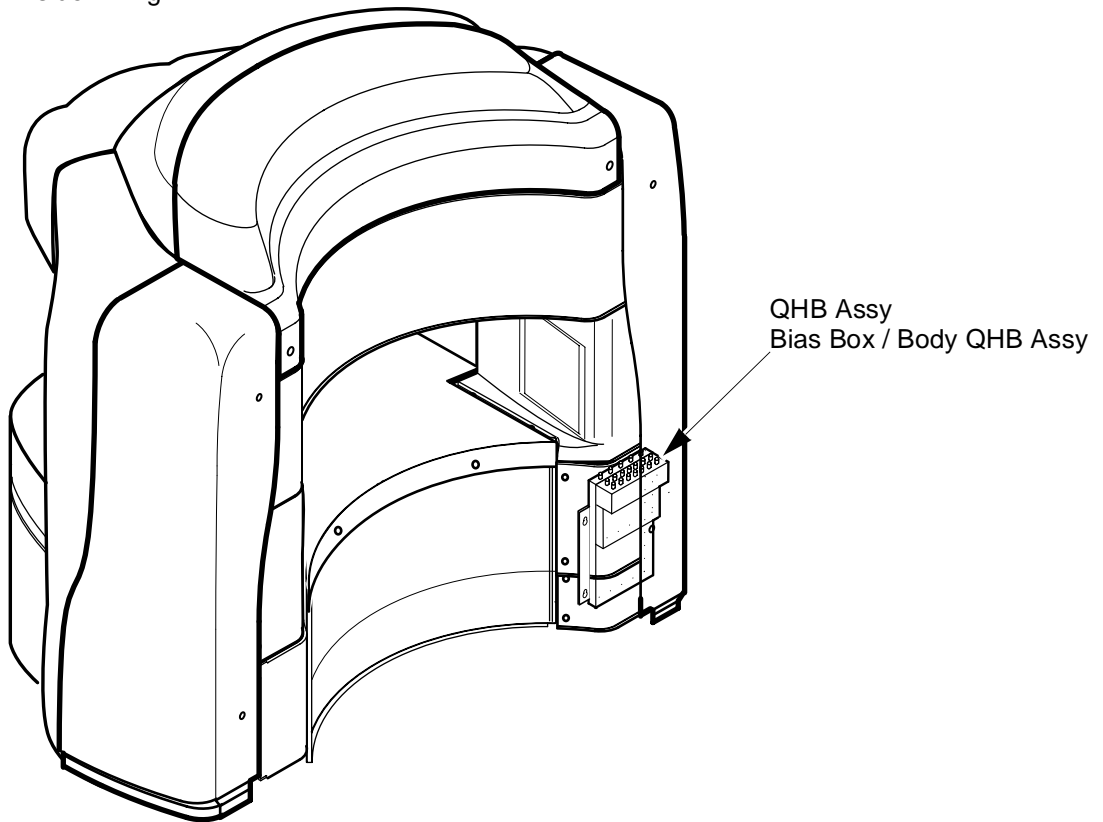

2. Preparation

Turn system switch power OFF.

Required Tool:

Items	Qty	Type/Parts Number	Part
Metric Allen Wrench Set	1	Non ferrous	Cover, QHB Assy
Phillips (+) Driver	1	Non ferrous	QHB Assy
Monkey Wrench	1	Non ferrous	Stud of Pre-Amp

Rev 1

3. Procedure

1. Remove the L Corner Cover by removing 2 screws(U0438AA) and 2 caps.

NOTE:The QHB is installed to opposite side of wiring side. This procedure is QHB of L side layout.

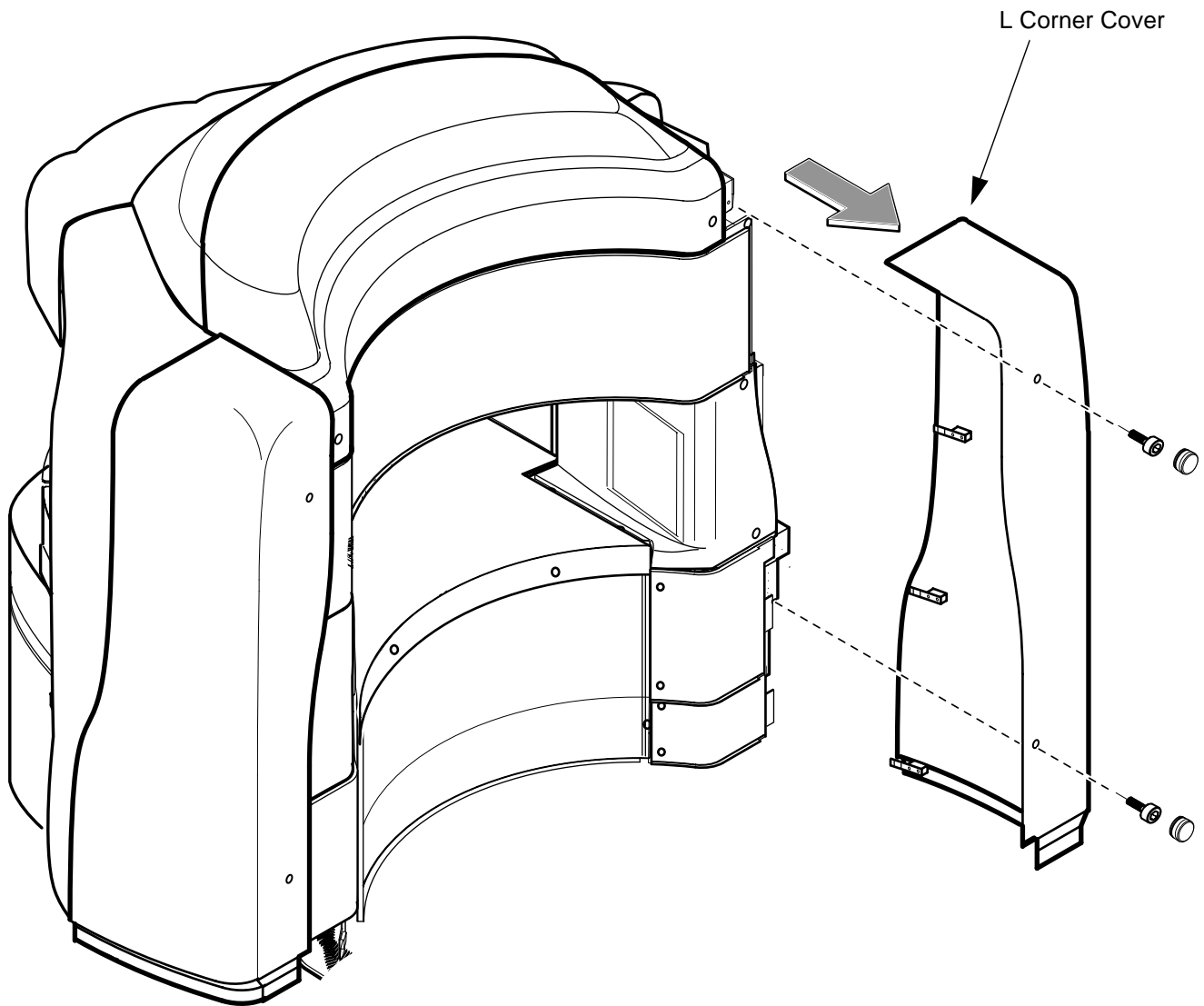

BIAS BOX / BODY QHB ASSY REPLACEMENT
ILLUSTRATION 1

Rev 1

3. Procedure(Continued)

2. Remove QHB Cover and Duct Blind Cover by removing 4 screws and caps.

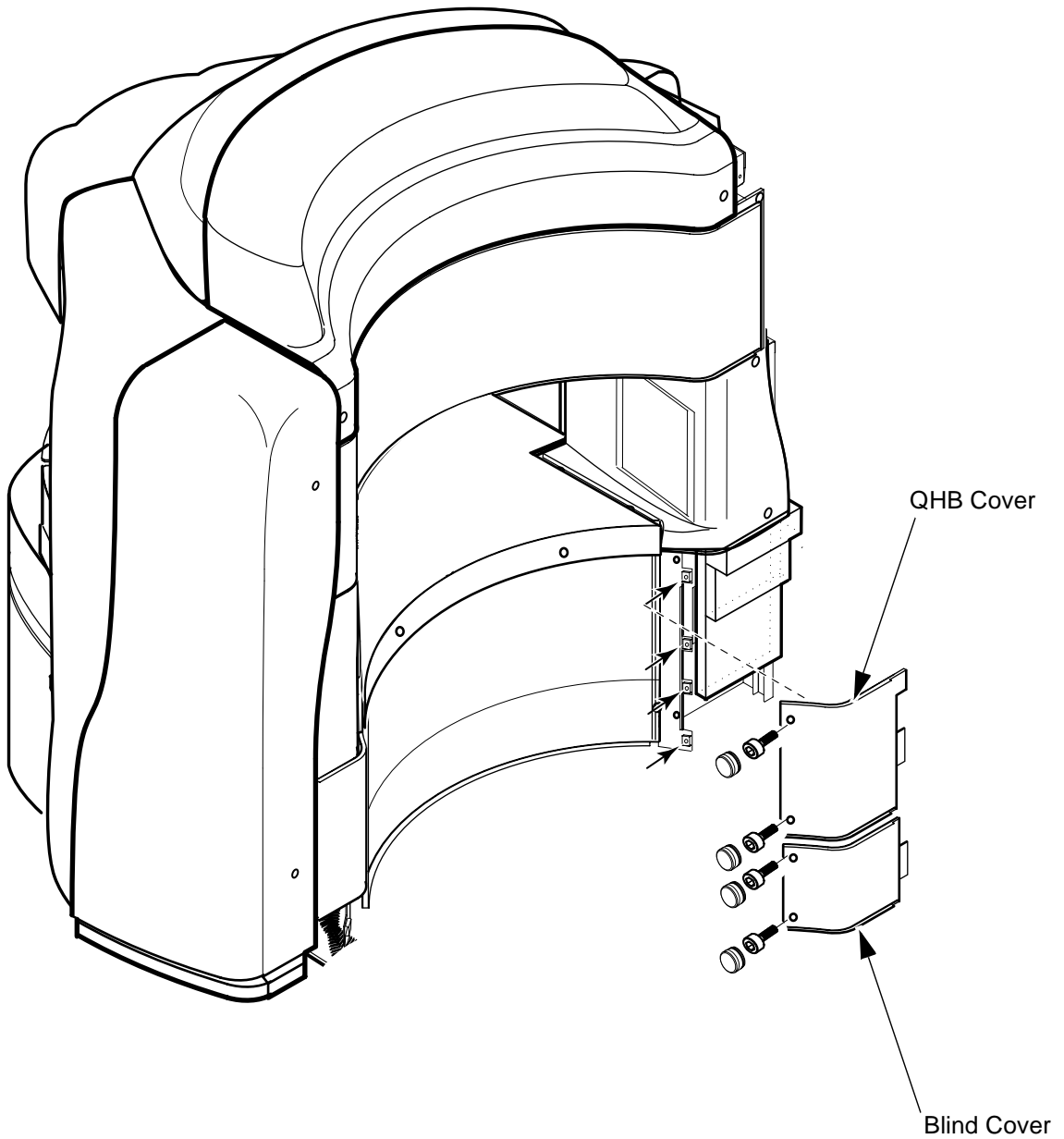

BIAS BOX / BODY QHB ASSY REPLACEMENT
ILLUSTRATION 2

Rev 1

3. Procedure(Continued)

3. Disconnect all cables from QHB upper and lower side panel.
4. Reuse the following items to new QHB unit.
 - QHB Jumper Cable x4
 - N-L Angle Adapter U1046FD
 - QHB-Preamp Cable (2293722)

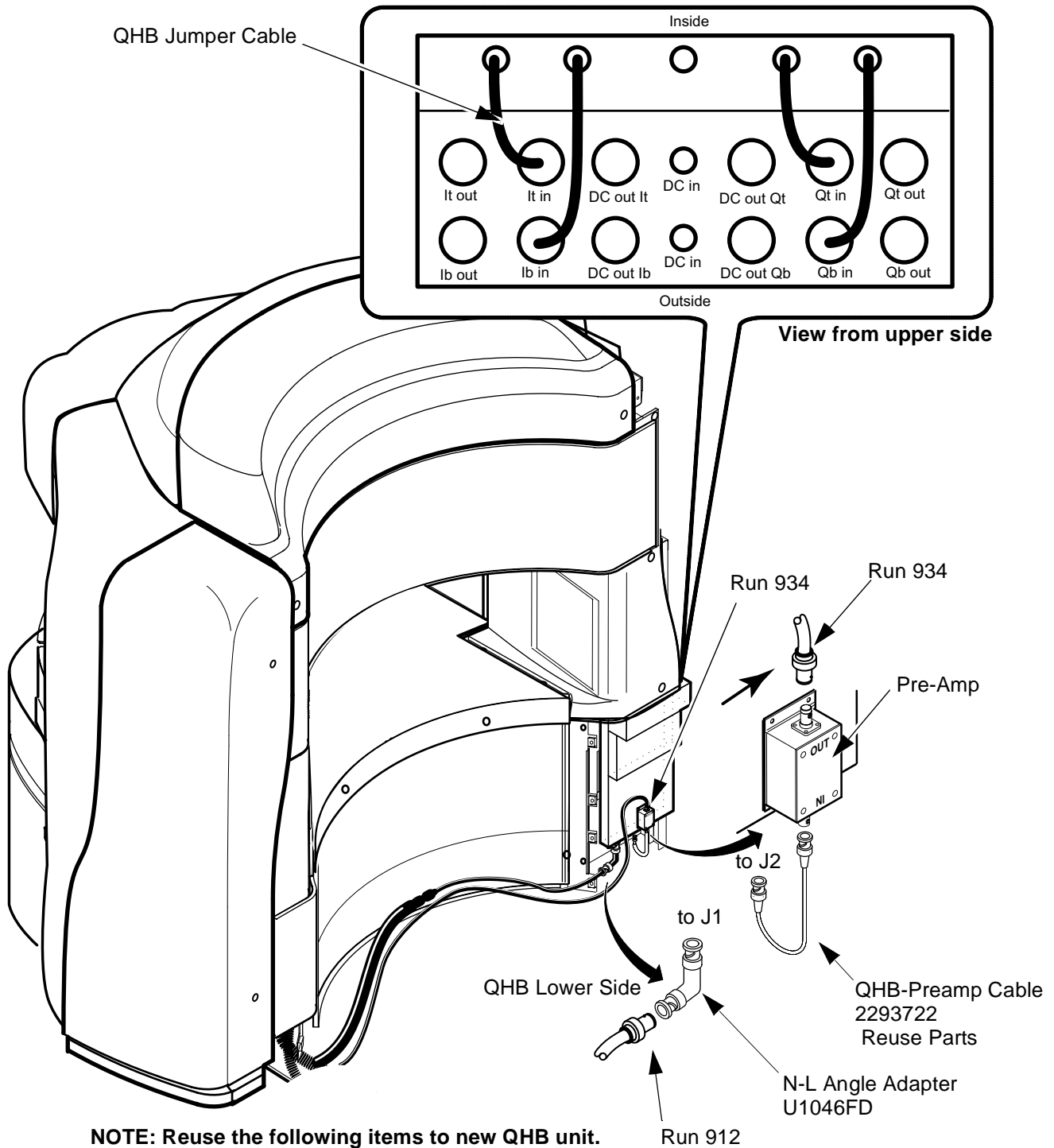

NOTE: Reuse the following items to new QHB unit.

**BIAS BOX / BODY QHB ASSY REPLACEMENT
ILLUSTRATION 3**

Rev 1

3. Procedure(Continued)

5. Loosen 4 screws of QHB tightening to the magnet lower frame. Do not remove 4 screws.
6. Remove QHB Assy from the magnet rear side.

NOTE:Check that QHB is installed to lower hole of rear lower frame.

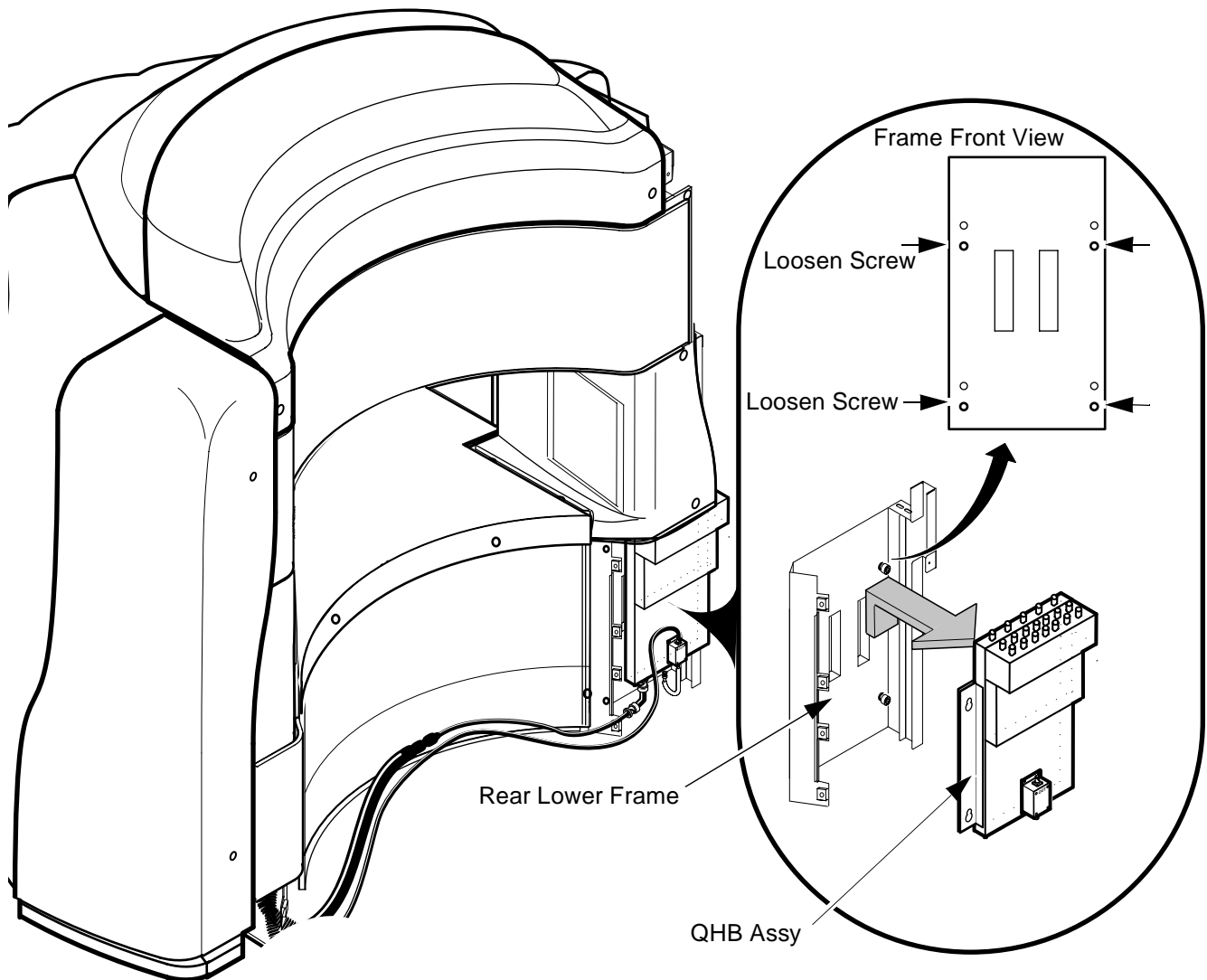

BIAS BOX / BODY QHB ASSY REPLACEMENT
ILLUSTRATION 4

Rev 1

3. Procedure(Continued)

7. Remove Bias Box by removing 4 screws(U0438AA).
8. Remove pre-amp by removing 3 studs from body QHB Assy.
9. Reuse the pre-amp to new body QHB assy.
10. Separate 2 BRKTs by removing 4 screws from Body QHB Assy.

NOTE: Reuse the Pre-amp to new body QHB Assy.

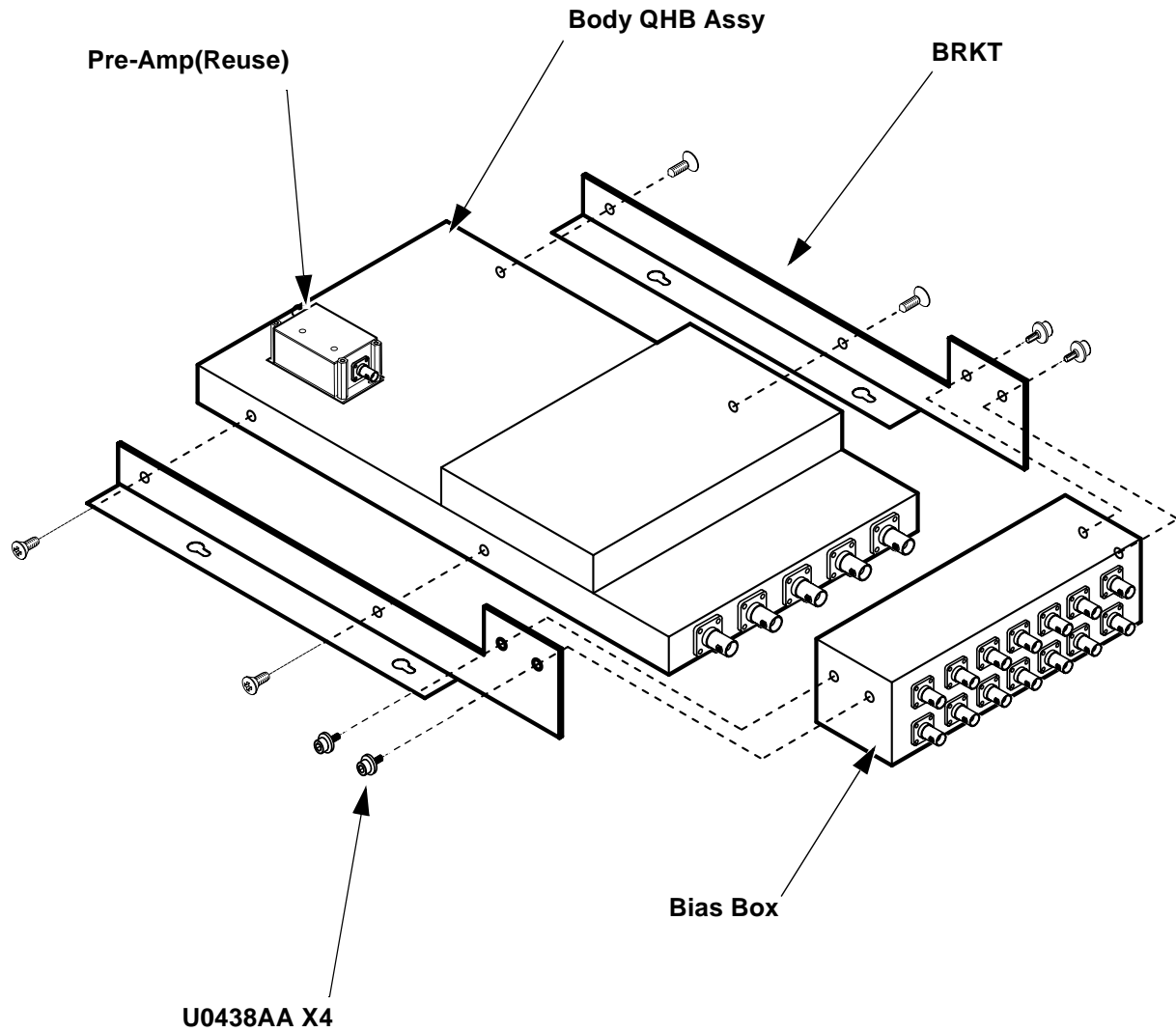

**BIAS BOX / BODY QHB ASSY REPLACEMENT
ILLUSTRATION 5**

Rev 1

4. Restoration

1. Installation is reverse order of removal.
2. Turn system switch power ON.
3. Perform Body Power Check. Refer to body power check in installation flow.

Rev 1

Revision History

Rev	Date	Author	Primary Reasons For Change
0	Oct 03, 2001	K.Tsumagari	Initial Version
1	Jan 10, 2002	K.Tsumagari	Misc change