

TABLE RAIL INSTALLATION

TABLE OF CONTENTS

Table of Contents	1
1.Overview	2
2.Preparation	2
3.Table Front Rail Installation.....	3

Rev 3

1. Overview

This document describes how to install the table front rail.

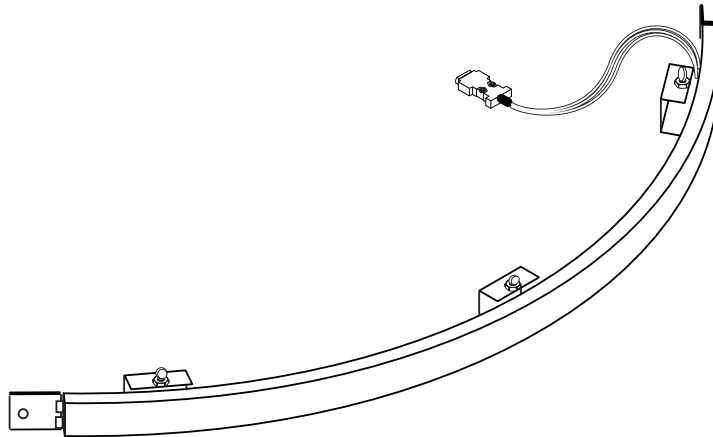

RAIL OVERVIEW

2. Preparation

1. Verify that the following parts are already installed before starting the table rail installation.

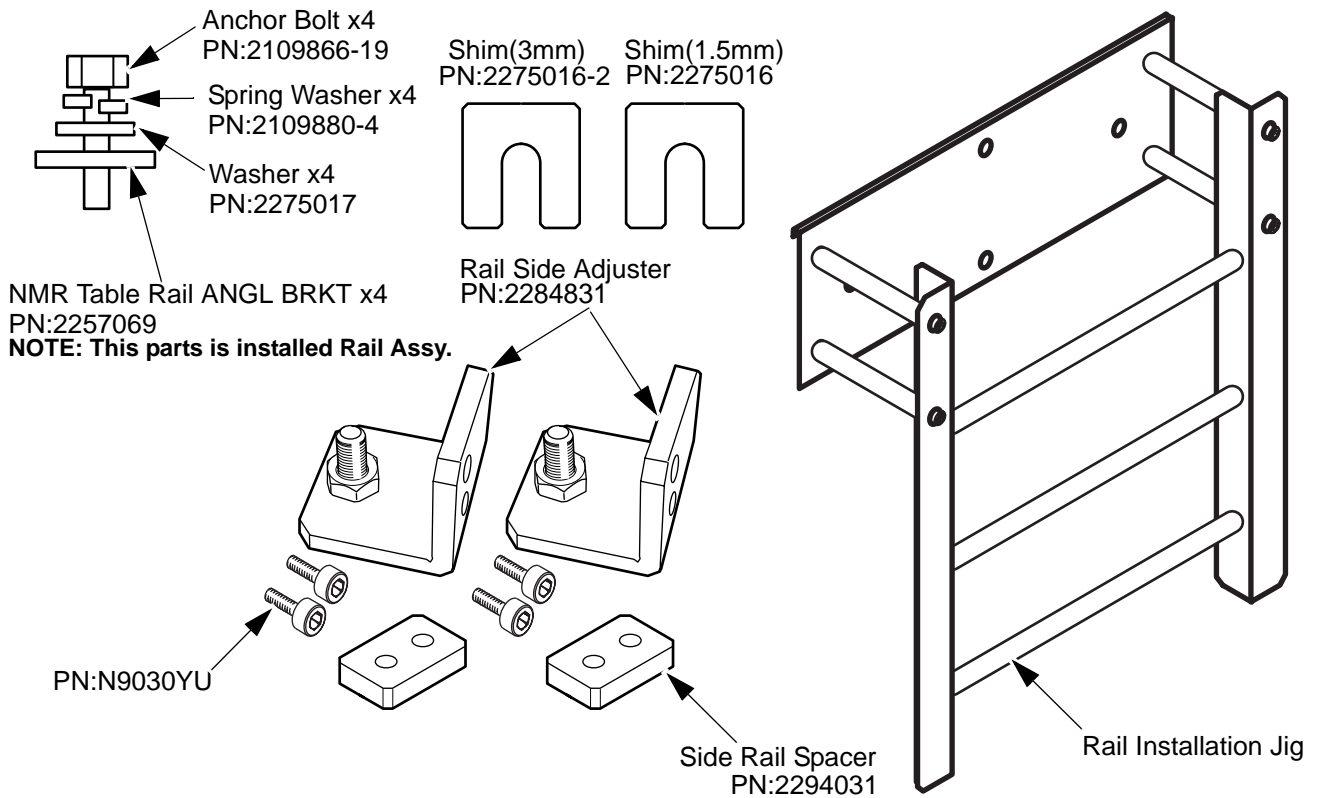

PREPARATION ILLUSTRATION 1

Required Tool:

Items	Qty	Type/Parts Number	Part
Ruler	1	Non ferrous	
Level Gauge	1	Non ferrous	

Rev 3

3. Table Front Rail Installation

1. Remove three insulators from magnet front as described in the following illustration.

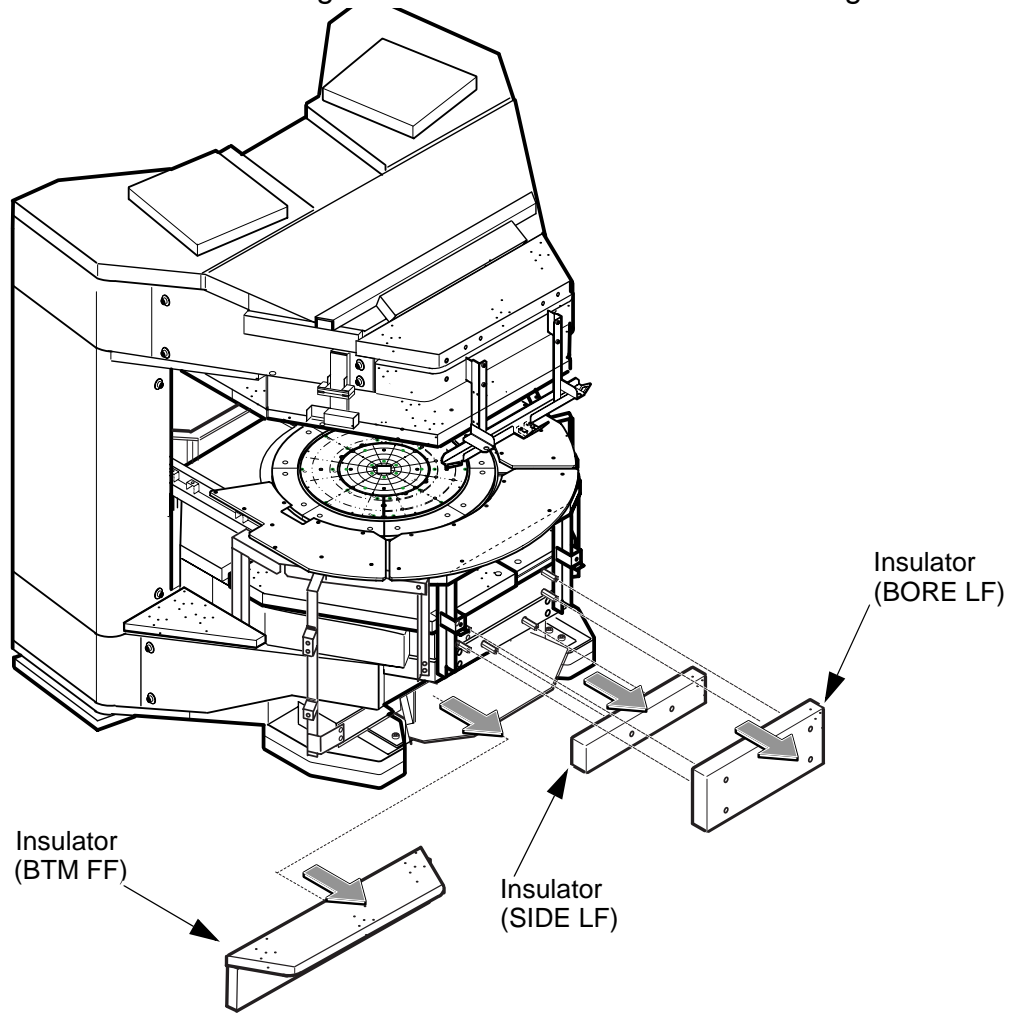

**INSULATOR REMOVAL
ILLUSTRATION 2**

2. Remove two screws and remove rail end brackets at both sides of the rail

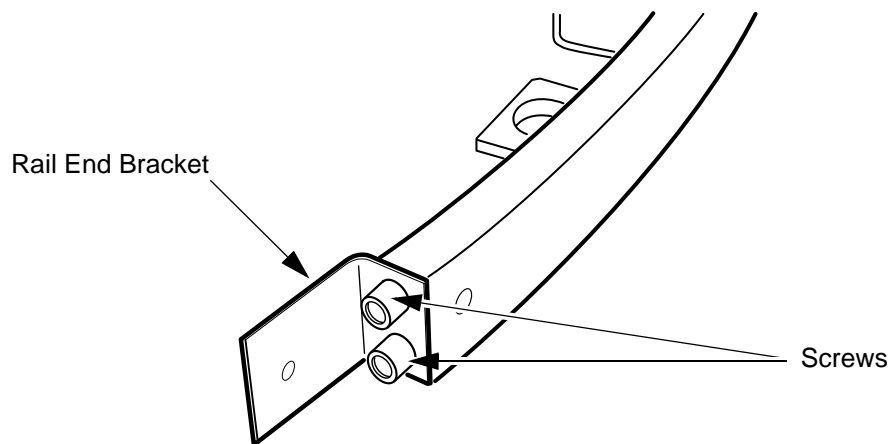

**RAIL END BRACKET REMOVAL
ILLUSTRATION 3**

Rev 3

3. Table Front Rail Installation (Continued)

3. Install Spacer(PN:2294031) and Rail Side Adjuster(PN:2284831) with two screws(N9030YU x2) at both sides of the rail.
4. Loosen the Nut(PN:N9101BM) of Rail Side Adjuster, and contact the bolt head(P9408ZM) to floor rotating the bolt.
5. Tighten the nut.

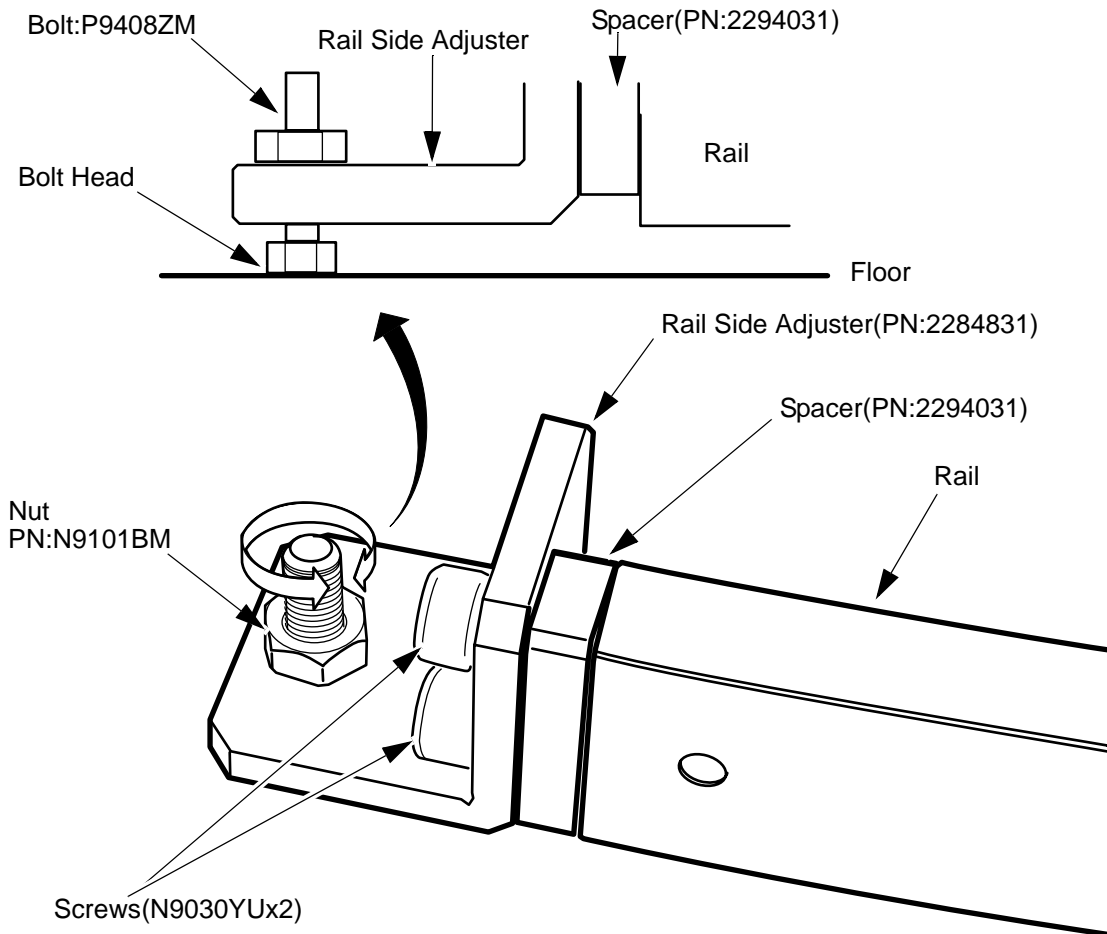

**RAIL SIDE ADJUSTER INSTALLATION
ILLUSTRATION 4**

Rev 3

3. Table Front Rail Installation (Continued)

- 10. Check level of rail using level gauge.
- 11. If there is inclination, level the rail with shim.
- 12. Recheck the rail position with rail alignment jig.
- 13. Fix the Rail to floor with four anchor bolts.

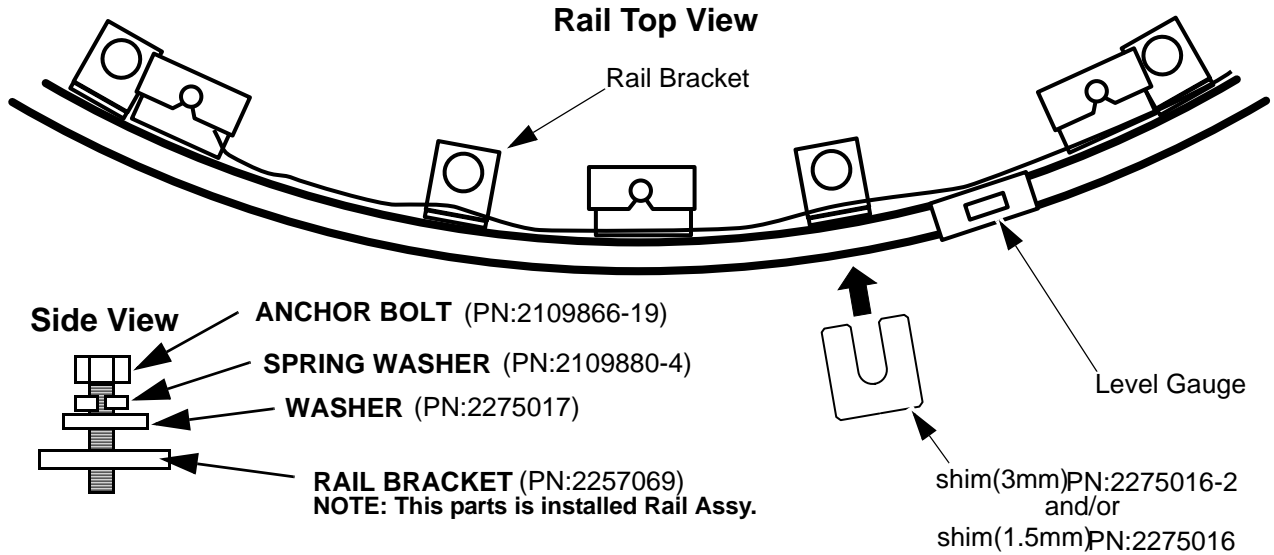

RAIL LEVEL CHECK AND ANCHORING
ILLUSTRATION 6

- 14. Remove three pivot sensors by loosening nut to installing the table. If you do not remove sensors, it hits table under side, and the table is not installed to the rail.

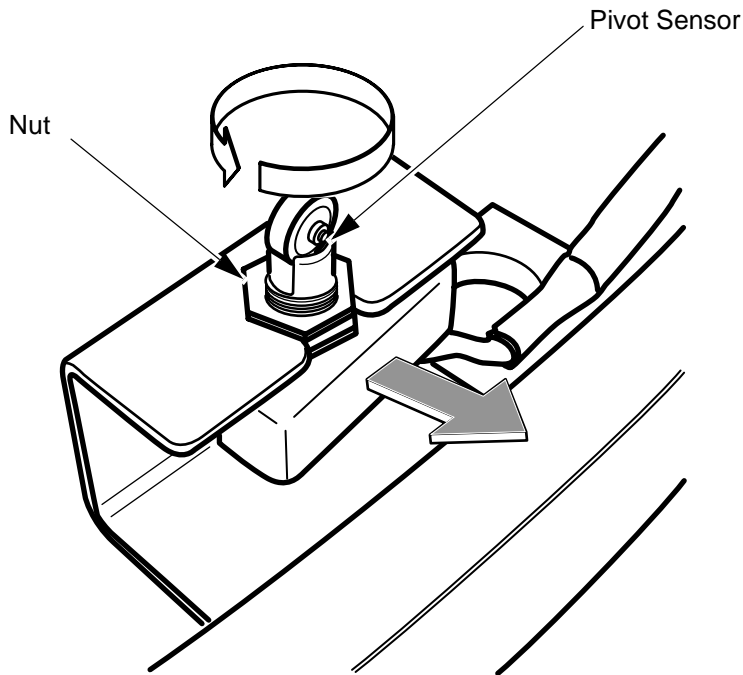

PIVOT SENSOR REMOVAL
ILLUSTRATION 7

Rev 3

3. Table Front Rail Installation (Continued)

15. Restore the three insulators.

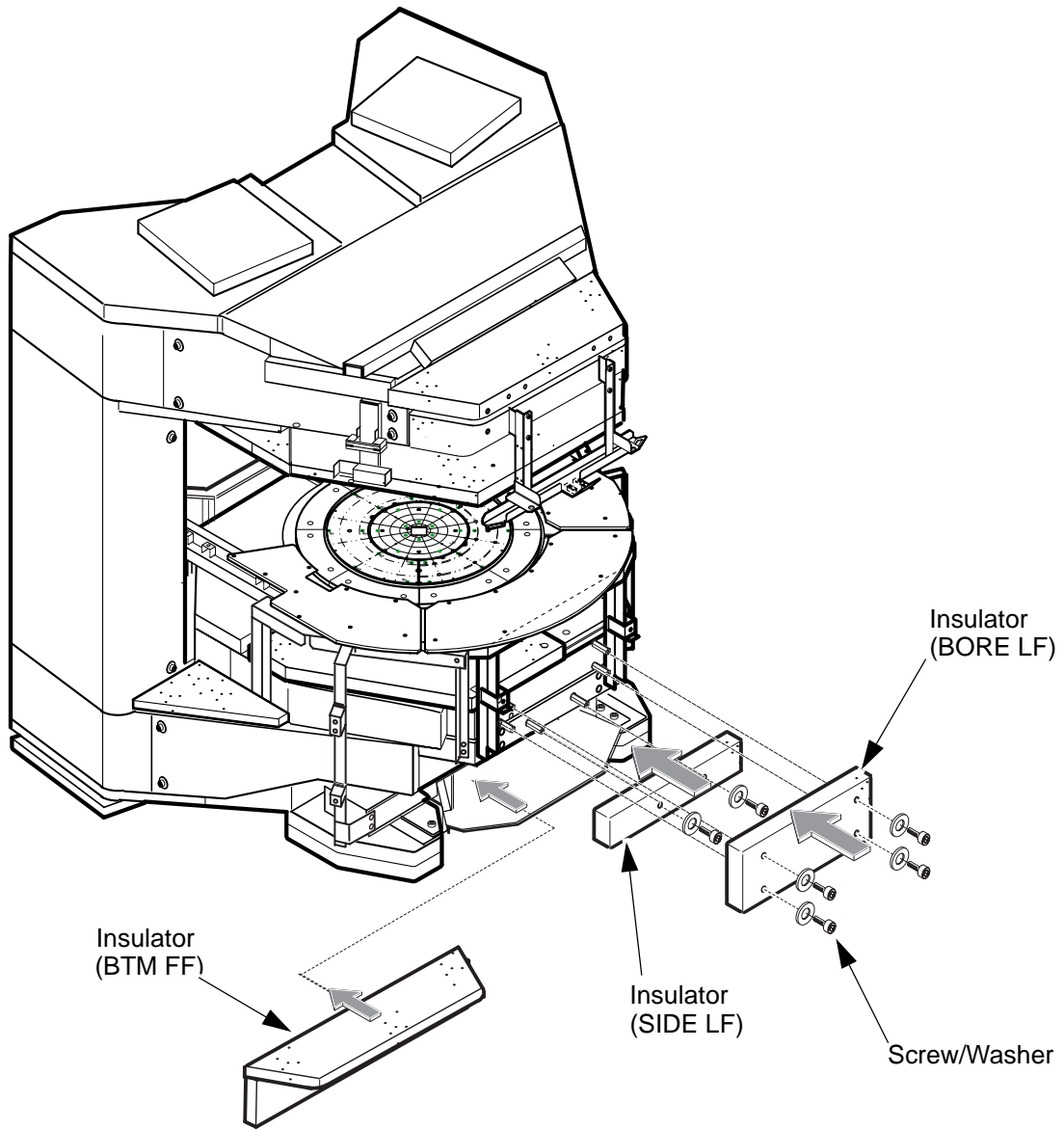

INSULATOR INSTALLATION
ILLUSTRATION 8

Rev 3

Revision History

Rev	Date	Author	Primary Reasons For Change
0	Mar 14, 2001	K.Tsumagari	Initial Release
1	May 19, 2001	K.Tsumagari	Parts number is added
2	Jan 10, 2002	K.Tsumagari	Misc change
3	May 9, 2003	Y.Masumo	P5: Error Correction concerning jig attachment in illustration5.