

TABLE OF CONTENTS

1- DESCRIPTION	2
2- STARTING THE IMAGE EXTRACTION TOOL	2
3- NAVIGATING THE MENUS.....	3
4- SELECTING AN EXAM, SERIES AND IMAGES BY NUMBER.....	4
5- SELECTING AN EXAM, SERIES OR IMAGE FROM A LIST	7
6- EXITING THE IMAGE EXTRACTION TOOL	11
REVISION HISTORY	12

1- DESCRIPTION

This document describes the procedure for extracting images from the image database for On-Line Center downloading.

2- STARTING THE IMAGE EXTRACTION TOOL

1. In the Service Desktop Manager, click on the **[Service Browser]** button.
2. Follow the instructions in Illustration 2-1, below.

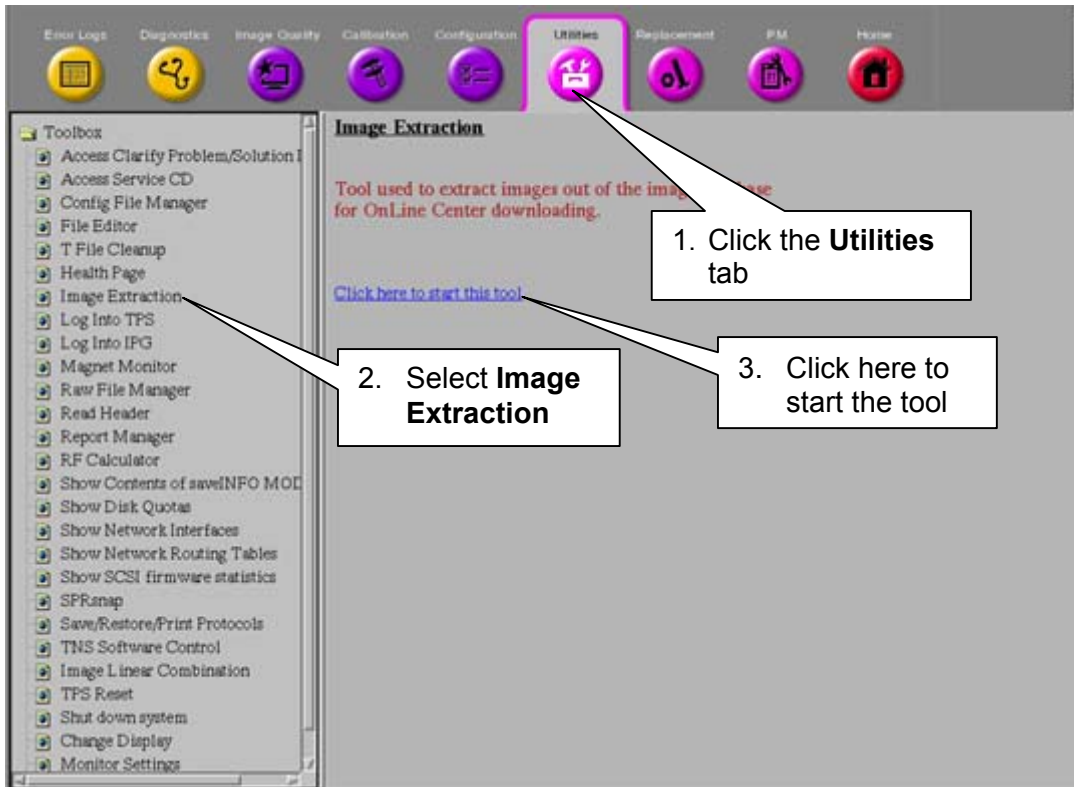

STARTING THE IMAGE EXTRACTION TOOL
ILLUSTRATION 2-1

3. In the *winterm* window, you'll be prompted to type the insite password. Type **2getin** (in either upper- or lowercase), then press **<Enter>**. Note that the password will not appear on the screen as you type.

The Main Menu appears in a *winterm* window. Refer to Illustration 2-2.

```
=====
                                MAIN MENU
=====

Exam_No = 0,   Series_No = 0,   Image_No = 0

A. Select Exam
B. Select Series
C. Select Images
D. List/Select Exam
E. List/Select Series
F. List/Select Image
Q. Quit
YOUR CHOICE :
```

IMAGE EXTRACTION MAIN MENU
ILLUSTRATION 2-2

Main Menu options allow you to enter Exam, Series and Image numbers if you know them, or, if you're not certain about the numbers, you can select them from a list.

- If you know the number of the Exam, Series and Image you want to view, follow the *Selecting an Exam, Series and Image(s) by Number* procedure in Section 4.
- If you're not sure of the numbers, but can identify the Exam, Series and Image by details or descriptions stored in the database, follow the *Selecting an Exam, Series or Image from a List* procedure in Section 5.

Note

Regardless of the extraction method you use, you can still select an Exam, Series or Image(s) from a list if any of the numbers you enter are not in the database. You must select the items in this order: Exam, then Series, then Image(s).

3- NAVIGATING THE MENUS

- To make selections from the menus, the pointer must be within the *winterm* window.
- Only ten items (exams, series or images) can be displayed at once. To display the next ten items, use the navigational keys at the bottom of the screen:

```
<F: First Page> <N: Next Page> <P: Prior> <L: Last Page> <1-10: Entry>
```

- If you're in a submenu (e.g., the Series menu) and you want to return to the previous menu, type **Q** at the prompt and press **<Enter>**.
- If you're at the Main Menu, type **Q** to return to the Service Browser.

4- SELECTING AN EXAM, SERIES AND IMAGES BY NUMBER

Use this procedure if you know the exam, series and image numbers you're looking for. If you enter a number that doesn't exist in the database, the system will display a menu of all entries from which to choose.

1. **To select an exam by number**, on the Main Menu, type **A** (in upper- or lowercase) and press **<Enter>**.
2. At the prompt **Exam No. ?**, type the exam number you want to view. Press **<Enter>**.
 - a. **If you typed an existing exam number**, the Main Menu will reappear. Go to step 3.
 - b. **If you typed an exam number that doesn't exist in the database**, the Exam Menu will appear, from which you can select an Entry number. See the example in Illustration 4-1.

Page 1 of 1					
Entry	Exam	Patient Name	Date	A	Exam Description
1	50022/MR	*	10/17/2002	N	
2	878/TWIN	*	10/17/2002	N	MRA Renal
3	58/MR	*	10/18/2002	N	
<1-3:Entry> [1] :2					

EXAM MENU
ILLUSTRATION 4-1

- c. On the Exam menu, type the *Entry* number (not the exam number) preceding the desired exam, then press **<Enter>**. When the Main Menu reappears, go to step 3.
3. **To select a series by number**, on the Main Menu, type **B** and press **<Enter>**.
4. At the prompt **Series No. ?**, type the series number (in the previously-selected exam) that you want to view. Press **<Enter>**.
 - a. **If you typed an existing series number**, the Main Menu will reappear. Go to step 5.

- b. **If you typed a series number that doesn't exist in the database**, the Series menu will appear, from which you can select an Entry number. See the example in Illustration 4-2.

```
page 1 of 1
Patient Name: *
Patient ID : *
Exam Num : 50025/MR
Exam Date : 09/13/2002
```

Entry	Ser	Img	Plane	Scan Range	PSD	Type	Series Description
1	1	1	Ax	S0.0 - S0.-0	SE	PROSP	TORSO,Ax,2D,SE
2	2	10	0	R0.6 - R0.6	FSE	PROSP	TORSO,Obl,2D,SE,Fast

<1-2:Entry> [1] :

SERIES MENU
ILLUSTRATION 4-2

- c. Type the *Entry* number (in the first column) that precedes the series you'd like to view, then press **<Enter>**. Go to step 5.
5. **To select an image or images by number**, on the Main Menu, type **C** and press **<Enter>**.

- a. When the prompt **Image No ?** appears, you'll also see this message:

Type in the start image number and end image you want to copy with a space in between.

- b. To select more than one image, you can enter a *range* of images separated by a space.

For example, to select images 81, 82, 83 and 84, enter **81 84**. To select a single image (e.g., image 7), type **7 7**.

Note

A range of images must be consecutive (for example, 1 to 10, or 256 to 30). You can only select a *range* of image numbers from option **C. Select Images**. If you select option **F. List/Select Image**, you'll have to choose the images one at a time.

- c. **If you typed an existing image number (or range of numbers)**, go to step 6.

7. If the image(s) you selected already exist(s) in the /usr/g/insite/tmp directory, you'll see a message like this:

```
Gzip: /usr/g/insite/tmp/e50022s1i8.gz already exists; do you wish to overwrite  
(y or n)?
```

Type **y** to overwrite the existing image or **n** to cancel the overwrite.

8. If the list contains more than 10 items, use the navigational keys at the bottom of the screen to move between "pages." See Illustration 4-4.

```
<F: First Page> <N: Next Page> <P: Prior> <L: Last Page> <1-10: Entry>
```

NAVIGATIONAL KEYS
ILLUSTRATION 4-4

Note

The tmp directory will be purged periodically, so if you need to view an extracted image that's been in the tmp directory for a few days, you may have to re-extract it.

5- SELECTING AN EXAM, SERIES OR IMAGE FROM A LIST

If you'd prefer to select the exam, series or image from a list of all entries in the database, follow the procedure below. Refer to Illustration 5-1.

```
=====
                        MAIN MENU
=====

Exam_No = 0,   Series_No = 0,   Image_No = 0

A. Select Exam
B. Select Series
C. Select Images
D. List/Select Exam
E. List/Select Series
F. List/Select Image
Q. Quit
YOUR CHOICE  :
```

IMAGE EXTRACTION MAIN MENU
ILLUSTRATION 5-1

1. **To select an exam from a list**, on the Main Menu, type **D** (in upper- or lowercase) and press **<Enter>**.

Note

The Exam_No, Series_No and Image_No at the top of the menu display the numbers of the currently selected items. A zero (0) indicates that there is no current selection for that item.

2. A list of the exams in the database is displayed. Refer to Illustration 5-2.

Entry	Exam	Patient Name	Date	A	Exam Description
1	50022/MR	*	10/17/2002	N	
2	878/TWIN	*	10/17/2002	N	MRA Renal
3	58/MR	*	10/18/2002	N	

<1-3:Entry> [1] :2

Entry number

EXAMS IN THE DATABASE
ILLUSTRATION 5-2

- 3. Each *Exam* number is preceded by an *Entry* number. At the prompt, enter the *Entry* number preceding the exam you're looking for (**not** the number of the exam itself). Then press **<Enter>**.
- 4. If the list contains more than 10 items, use the navigational keys at the bottom of the screen to move between "pages." See Illustration 5-3.

<F: First Page>	<N: Next Page>	<P: Prior>	<L: Last Page>	<1-10: Entry>
-----------------	----------------	------------	----------------	---------------

NAVIGATIONAL KEYS
ILLUSTRATION 5-3

Be sure the pointer is within the *winterm* window, then type the letter **N** to go to the next page, **P** to go to the prior page, etc.

- 5. When the Series Menu appears, select the *Entry* number of the series (the second column, labeled **Ser**) you want to view. Then press **<Enter>**. See Illustration 5-4.

7. If there are multiple “pages” of images, go to the next page by positioning the pointer anywhere in the *winterm* window, then type **N** and press **<Enter>**.

Other navigational keys, displayed below the menu, will allow you to move forward, backward, to the beginning and end of the list of images. See Illustration 5-6.

```
<F: First Page> <N: Next Page> <P: Prior> <L: Last Page> <1-10: Entry>
```

NAVIGATIONAL KEYS

ILLUSTRATION 5-6

8. To select a single image, type the number in the Entry column that precedes the image you want. Press **<Enter>**.

A message similar to this one will appear:

```
The image file will be copied to /usr/g/insite/bin/gzip/e58sli2
It will then be compressed with /usr/g/insite/bin/gzip
```

If the image already exists in the */usr/g/insite/tmp* directory, you’ll see a message like this:

```
Gzip: /usr/g/insite/tmp/e50022slil.gz already exists; do you wish to overwrite (y or
n)?
```

If you want to overwrite the existing file, type **Y**; if not, type **N**. Press **<Enter>**.

9. To select a *consecutive* range of images:
- Return to the Main Menu by typing **Q** at the Entry prompts.
 - At the Main Menu, type **C** (Select Images).

The prompt **Image No ?** appears with this message:

```
Type in the start image number and end image you want to copy with a
space in between.
```

- Type the first image number and the last image number, separated by a space.

For example, to select images 81, 82, 83 and 84, enter **81 84**. To select a single image (e.g., image 7), type **7 7**.

The message below will be repeated for each image you selected. The filenames are composed of the **exam**, **series** and **image** numbers.

```
The image file will be copied to /usr/g/insite/tmp/e58sli3
It will then be compressed with /usr/g/insite/bin/gzip
```

Note

The tmp directory will be purged periodically, so if you need to view an extracted image that's been in the tmp directory for a few days, you may have to re-extract it.

6- EXITING THE IMAGE EXTRACTION TOOL

1. If necessary, type **Q** at the current menu (Exam, Series or Image) and press **<Enter>** until you return to the Main Menu.
2. At the Main Menu, type **Q** and press **<Enter>** to return to the Service Browser.

REVISION HISTORY

REV	DATE	AUTHOR	PRIMARY REASONS FOR CHANGE
0	Oct. 24, 2002	C. MacDonald	Initial version